

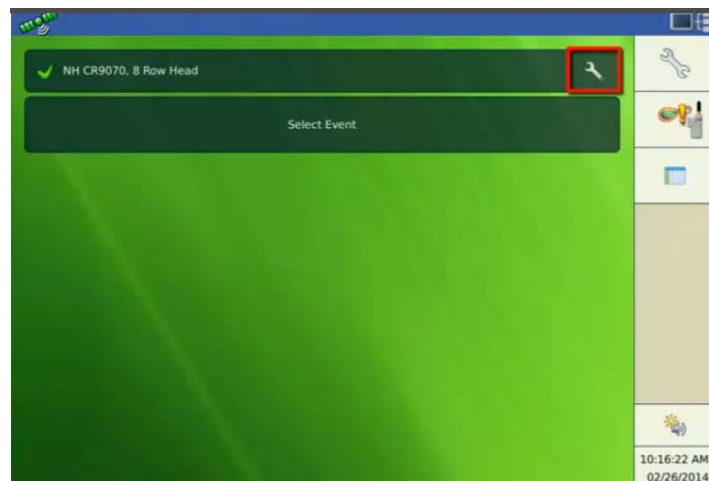

Distance Calibration Procedure

AgLeader Terminal

Procedure to make the auxiliary speed source accurate

Distance Calibration Procedure



- Select the appropriate combine from the configuration list and press the highlighted wrench icon to access the configuration setup screens. 

Distance Calibration Procedure

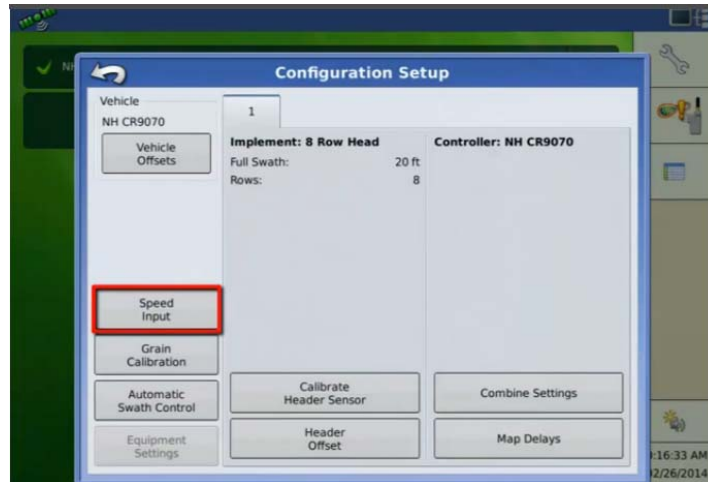

- ☐ Press the speed input button.



Distance Calibration Procedure

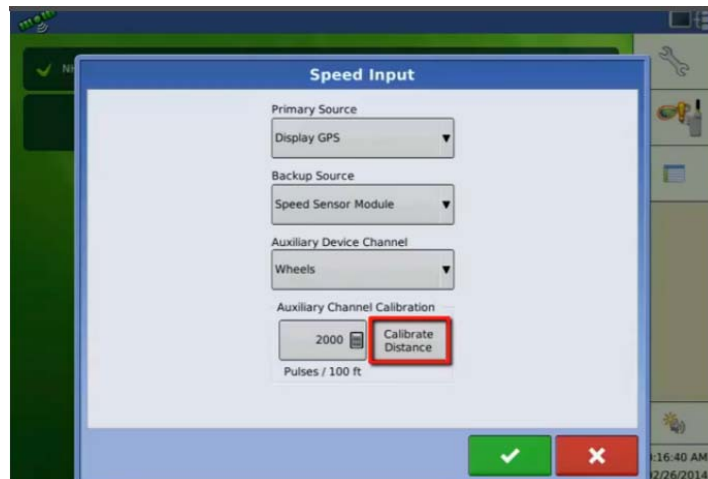

- ☐ On the speed input screen, select the calibrate distance icon. This will launch the speed sensor calibration wizard.



Distance Calibration Procedure

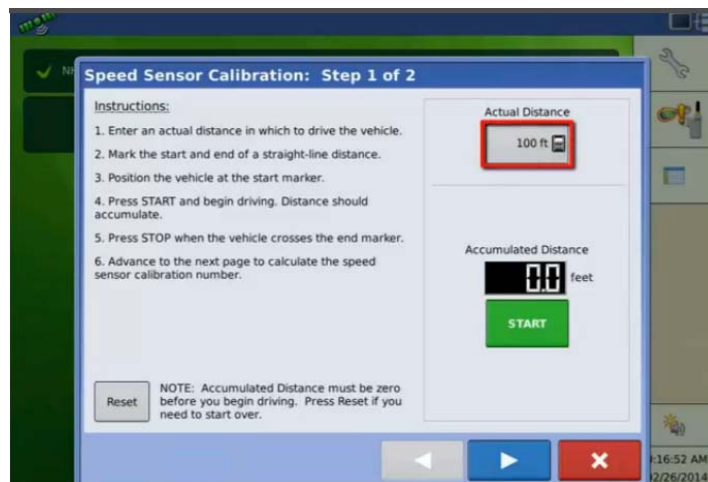

- ❑ The first step is to enter the actual distance the combine will drive during the calibration. AgLeader recommends a distance of 200 feet. Press the calculator icon to change this value.

Distance Calibration Procedure



- ❑ Physically measure the distance you inputted in the monitor and mark the start and end points. AgLeader recommends a distance of 200 feet.

Distance Calibration Procedure

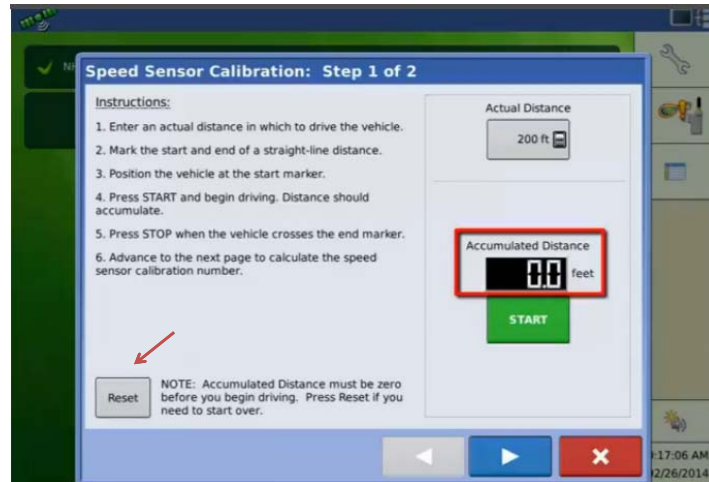

- ❑ With the vehicle at the start point, ensure the accumulated distance is at 0 feet. If not, press the “reset” icon to change this value. 

Distance Calibration Procedure

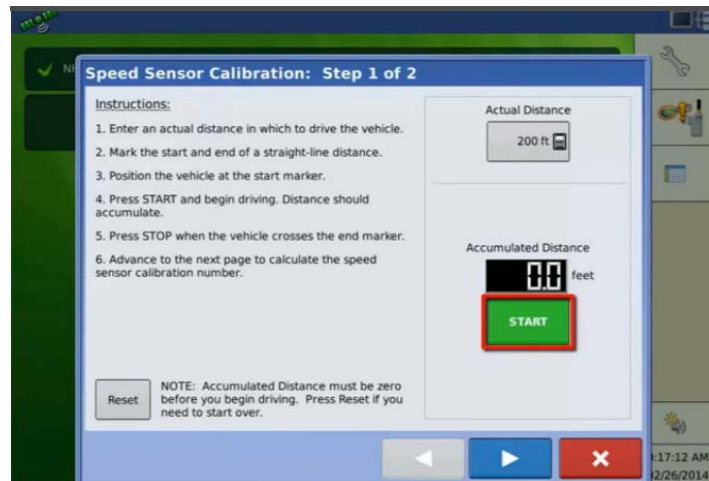

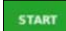
- ❑ Press “Start” and begin driving. 

Distance Calibration Procedure

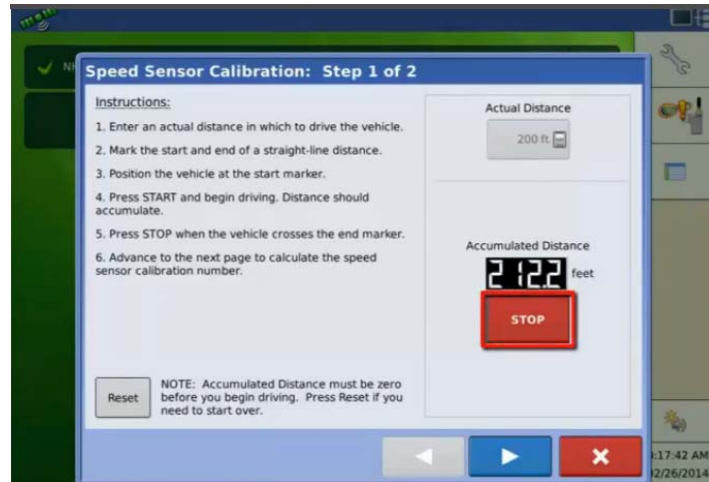

- Once you reach your marked endpoint, press "Stop".



Distance Calibration Procedure

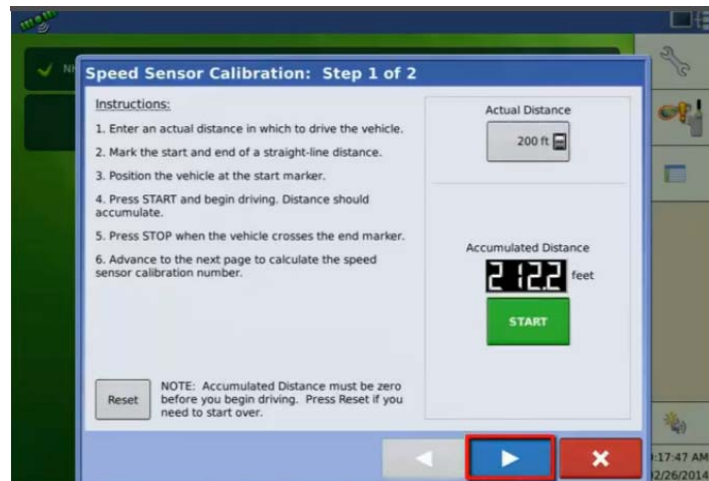

- Press the blue "next" arrow to continue.



Distance Calibration Procedure

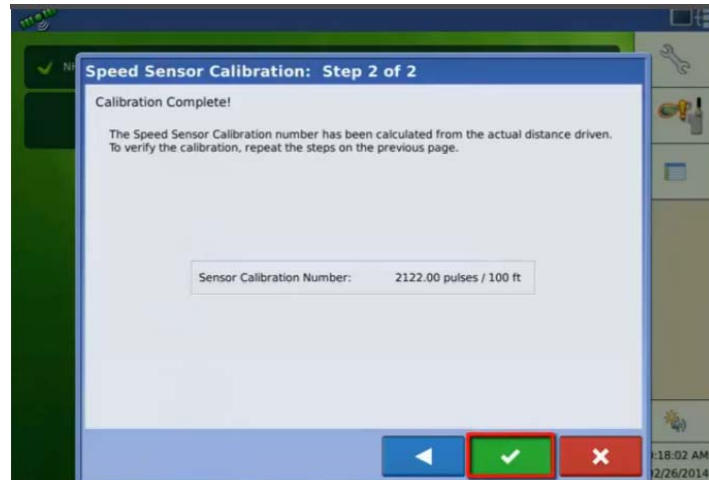

- ❑ Step 2 of the calibration procedure will display the new sensor calibration number. Press the green check to accept the new calibration.

Distance Calibration Procedure

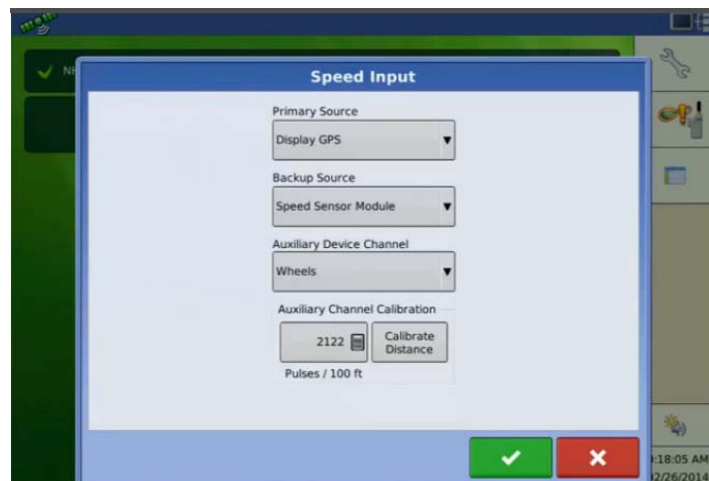

- ❑ This process can be repeated as necessary.